

# **Attachment D**

**Engagement Report Phase 2 and 3 –  
Redfern Neighbourhood Vision and Plan**

# Engagement report – Redfern neighbourhood vision and plan: Phase 2 and 3



# Contents

Overview	3
Background	3
Key Findings – Summary	5
Key Findings – Detailed – Phase 2	8
Key Findings – Detailed – Phase 3	21
Engagement activities	30
Appendices	31
Appendix A: Communications activities	31
Appendix B: A selection of the consultation materials	37

# Overview

---

## Background

Our Redfern neighbourhood vision and plan covers a part of Redfern that has gone through significant change in recent years. The Aboriginal Housing Company's Pemulwuy redevelopment was mostly complete at the time of consultation and new services have opened up. Aboriginal community members have moved back to the Block.

This is a place where many people live, work, study, visit, play, gather and pass through. It's an important place for the local Aboriginal community.

**Our community consultation on the Redfern neighbourhood vision and plan has occurred over 3 phases.**

**Phase 1** community vision consultation: November and December 2022.

We heard that in the future the community see the neighbourhood as:

- a place that celebrates its Aboriginal culture and history
- a place that is green and cool with native trees and plants
- a safe place to move around and play
- a place where people feel a sense of connection and belonging
- a place where the community can come together to socialise and celebrate.

This community vision helped us shape a plan to improve the local parks and streets, including 3 main opportunities:

1. improvements to Redfern Community Centre Open Space
2. improvements to Yellomundee Park and Hugo Street Reserve
3. slowing traffic and greening the streets.

Consultation on the plan was conducted in two phases.

**Phase 2:** data was collected on all 3 opportunities between June-July 2023.

**Phase 3:** Phase 2 data was used to refine the plans for Redfern Community Centre Open Space, Yellomundee Park and Hugo Street Reserve. The community was then consulted on the revised park plans in October 2023.

This report details the outcomes of phase 2 and phase 3 community consultations.

---

## Purpose of engagement

### Phase 2: purpose of the Redfern neighbourhood vision & plan consultation was to:

- report back to the community on outcomes of Phase 1, including making the Phase 1 consultation report available to the public.
- consult the community and gather feedback on draft concept plans for three areas of focus: Redfern Community Centre Open Space; Yellomundee Park & Hugo Street Reserve; and calming and greening local streets

### Phase 3: purpose of the Redfern neighbourhood vision & plan consultation was to:

- report back to the community on outcomes of Phase 2.
- Seek community feedback on the revised plans for Redfern Community Centre Open Space, Yellomundee Park and Hugo Street Reserve
- Update the community on the next steps for calming and greening the streets, including developing a Local Area Traffic Management plan (LATM) that would be subject to future consultation.

---

## Outcomes of engagement

From **29 June – 20 July 2023, (phase 2)** we sought feedback on the concept designs for Redfern Community Centre Open Space, Yellomundee Park, Hugo Street Reserve and slowing traffic and calming streets. **60 people** attended a **community workshop** hosted by Lord Mayor Clover Moore AO at the Redfern Community Centre on the 29 June, and **120 people provided feedback** in the subsequent three weeks via hardcopy/online surveys and emails.

Then from **12 October – 27 October 2023, (phase 3)** the community were given the opportunity to comment on the revised plans for the local parks based on feedback gathered during June and July. **47 people** attended a **Community meeting** hosted by Lord Mayor Clover Moore AO at the Redfern Community Centre on the 12 October. Feedback was collected at the meeting and in the subsequent two weeks via **10 email submissions**.

### Engagement snapshot

Phase 2 (29 June – 20 July 2023)		Phase 3 (12 – 27 October 2023)	
120	people provided feedback	57	people provided feedback
118	surveys completed	66	comments on display boards
2	email submissions	10	email submissions

---

Phase 2 (29 June – 20 July 2023)		Phase 3 (12 – 27 October 2023)	
60	attended Community workshop on 29 June	47	attended Community meeting on 12 October

---

## Participation

A diverse range of community members participated in the consultations from over 10 cultural backgrounds. Of those who chose to supply demographic information:

- 56% of respondents identified as Female and 44% as Male.
- Ages ranged from 16-80 years

### Cultural background:

- 40% of people identified as Aboriginal, Indigenous, Indigenous Australian or First Nations
- 35% of people identified as Australian with mixed cultural backgrounds including Asian, Irish, British, Greek and European
- 25% of people identified as from a range of cultural backgrounds including: Fijian, Italian, New Zealand, American, South American and Chinese.

---

## Key Findings – Summary

The below is a summary of what we heard from the community during phase 2 & 3 community consultations.

### Phase 2

Phase 2 of the consultation found that the **majority community sentiment** towards the **initial concept designs** for the largest park areas of Hugo Street Reserve and Redfern Community Centre Open Space was **negative**.

- 59% did not support Hugo Street Reserve initial design
- 51% did not support Redfern Community Centre Open Space initial design

The proposal to move the basketball court from its current location in the Hugo Street Reserve to the Redfern Community Centre Open Space was the largest single source of contention. This prompted changes to the design, including the retention of the basketball court in the Hugo Street Reserve.

### Phase 3

In Phase 3 of the consultation the community expressed **broad support** for all **redesigned park layouts** and the consultation process.

- 70% of comments at the community meeting were positive about the redesigned park plans

- 70% of written submissions via email expressed overall support for the redesigned park plans

## Parks

Summary of findings for each park after Phases 2 and 3 of consultation

### Hugo Street Reserve

- There is strong support for retaining the basketball court in the Hugo Street Reserve. Noise from the basketball court is a concern and noise attenuation measures need to be put in place
- Retention of gated park for dogs was split with a slight majority wanting to retain a gated off-leash area
- People supported a park with upgraded lawn areas, with more trees and greening, more seats and lighting
- People supported the protection of the 'United we stand, divided we fail the future' mural along the park's western park edge.

### Redfern Community Centre Open Space

- The community supported maximising the park green space in front of the community centre
- Community supported the addition of BBQs and increased seating
- There was support for the larger playground – in particular the addition of waterplay
- Support was expressed for activating the Redfern terrace.

### Yellomundee Park

- There is strong support for a community garden, including Indigenous planting
- Strong support for communal seating was expressed
- The park redesign is seen as an opportunity to create a social space for sharing knowledge and culture

## Calming and Greening the streets

Summary of findings for calming and Greening after Phases 2 and 3 of consultation

### Traffic calming and greening is important to the community

#### Integrate traffic plan with surrounding areas

- Traffic management within the consultation area should be integrated with the wider area and specifically with Transport for NSW (TfNSW)'s proposal and traffic plan
- Traffic flow and bottlenecks in surrounding streets (Lawson Street, Gibbons Street and Regent Street) should be considered when making traffic changes.

### Parking

- It is important to preserve resident parking and disabled parking spots

- Traffic could be discourage from entering the area by changing parking conditions - including: shorter parking time limits, resident-only parking
- Loss of parking on Lawson Street and Little Eveleigh Street was identified as a particular issue
- Better manage parking issues when large-scale construction occurs in the area so residents are not disadvantaged

### **Congestion and safety**

- The shared zone on Eveleigh Street between Caroline and Lawson Streets is a safety and congestion issue
- There is concern that shared zones can present dangers to children who may not realise they are still walking on a road used by cars
- Proposed changes could result in extra congestion in the area and push more traffic on to currently quiet streets

### **Ongoing community consultation and data analysis**

- The community want to be involved in ongoing consultation regarding any traffic changes
- The community want more information about the effectiveness of traffic proposals being put forward
- The community want to see the use of traffic data analysis to develop traffic solutions.

### **Greening**

- Greening of the area is supported
- Increased trees on Eveleigh Street was requested
- Request to not remove trees from parks was made
- A preference for non-allergenic plants and the use of non-introduced species was expressed
- Verge planting by council on Abercombie street was praised but that it requires trained gardeners to take care and maintain the vegetation.
- Community members request that residents and Council Gardeners are able to meet annually to coordinate the street verge planting efforts.

### **Waste and Cleaning**

Waste and cleaning within the local streets was raised as a significant issue, in particular:

- Residential bin storage is an issue for many of the terrace houses in the area. Solutions suggested include wider footpaths and a storage facility in Yellomundee Park
- Litter dropped by people passing through the area was raise as an issue, specifically university students and students residing at Scape. Particular streets mentioned: Abercrombie Street, Louis Street and Little Eveleigh Street.
- Solutions for littering mentioned were: education programs for students, more regular street cleaning and emptying of bins.
- Ensure there are enough bins installed in the parks and they are located in the right positions



## Phase 2 consultation – Detailed findings (parks initial design)

This section provides a detailed analysis of what the community told us during phase 2 consultation where feedback was sought on the initial concept designs for 3 local parks: Hugo Street Reserve, Redfern Community Centre Open Space & Yellomundee Park.

### Hugo Street Reserve

#### Hugo Street Reserve

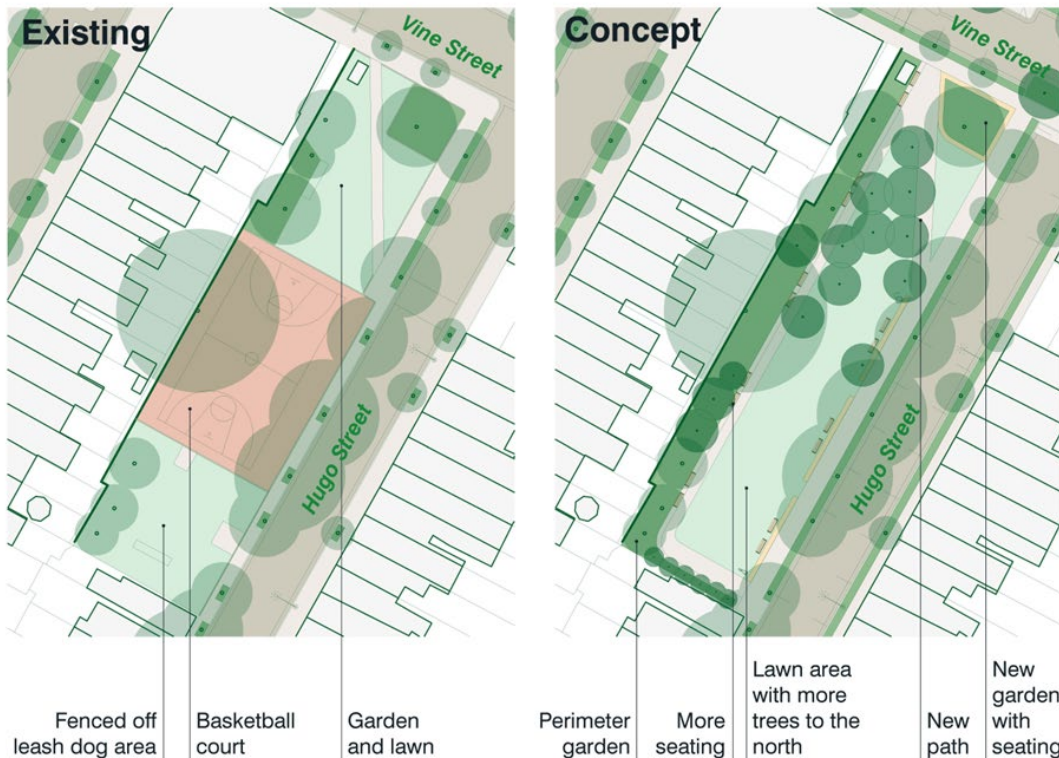

#### Overall sentiment

The majority of respondents to this question (59%) were negative or very negative about this design. 32% were positive or very positive, and 9% were neutral. A total of 106 people answered this question.

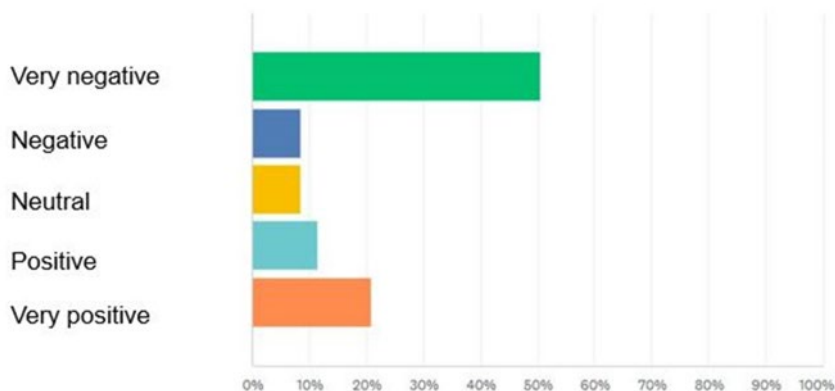

How people felt about this concept

People were then asked what they liked about the design and what could be improved?  
Percentage of 120 people.

**What people liked:**

- none of this concept (17%)
- removal of basketball court (15%)
- more green space (14%)
- removal of dog park (11%)
- space open to greater number of users (7%)
- the whole concept (4%)

**What could be improved:**

- retain the full-size basketball court and renovate (42%)
- retain the dog park (14%)
- move basketball court to northern end of the park (12%)

**Key topics in Hugo Street Reserve submissions**

**Basketball court**

The overall negative sentiment expressed in relation to the Hugo Street Reserve concept is primarily generated by the proposed removal of the basketball court. A combined 53% of those surveyed felt the basketball court should stay in the Hugo Street Reserve. This concern was voiced in both the Hugo Street Reserve section of the survey and the Redfern Community Centre Open Space section.

Those suggesting the court should stay specifically mentioned that it should be full-court in size, primarily so that two groups can play on the court at one time and that full-court games are still possible.

People noted that the court is an important free community resource fostering community building, friendship, health and wellbeing. Its potential role in helping to reduce anti-social behaviour was also mentioned.

15% of those surveyed noted their support for the court's removal, citing noise and the space it takes up as two reasons for their position.

**Dog park**

The dog park was a relatively significant topic of discussion but sentiment here is more balanced. Those in support of its removal (11%) suggested it would free up more space for other uses and reduce noise.

Those who suggested it should be retained (14%) included users of the park who would like it expanded in both size and in dog exercise equipment. Support also came from community members who felt safer knowing that dogs were in a fenced off area away from themselves and children.

## Redfern Community Centre Open Space

### Redfern Community Centre open space - Concept

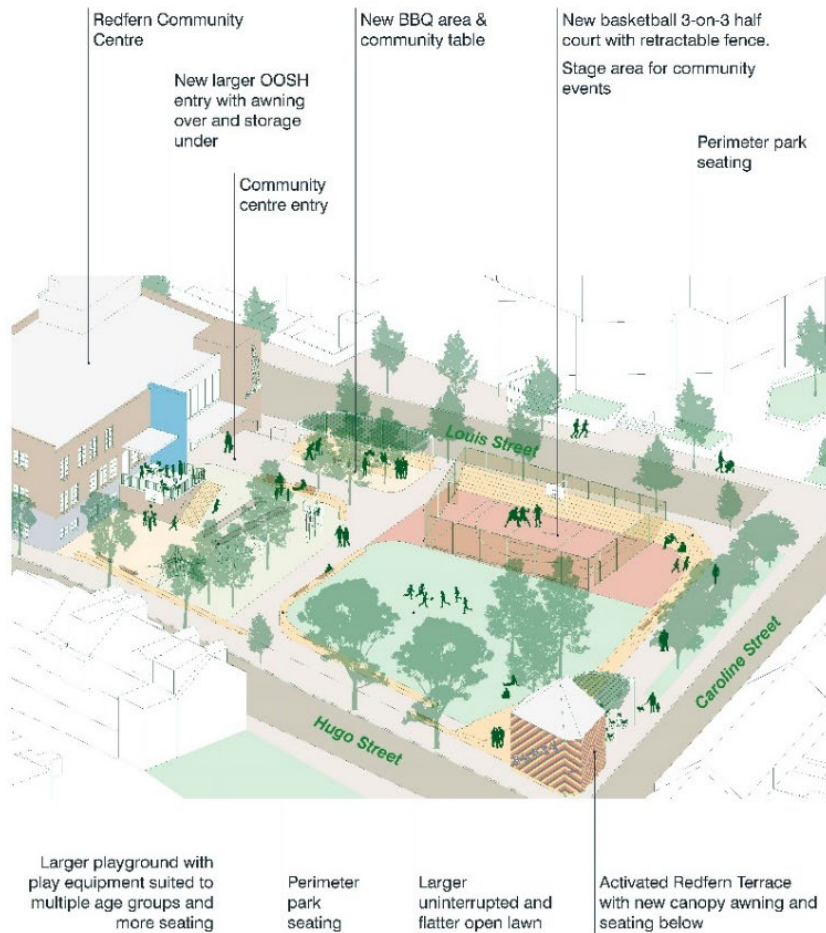

### Overall sentiment

Majority of respondents to this question (51%) were negative or very negative about the concept design. 40% were positive or very positive, and 9% were neutral. A total of 107 people answered this question.

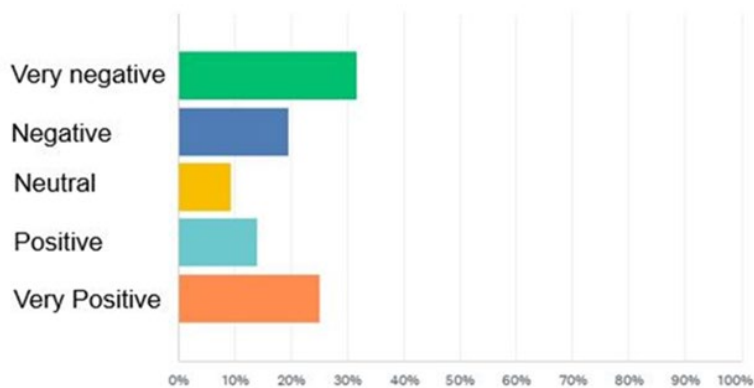

How people felt about this concept

<p>People were then asked what they liked about the design and what could be improved? Percentage of 120 people.</p>	
<p><b>What people liked:</b></p> <ul style="list-style-type: none"> <li>• larger green space (24%)</li> <li>• barbeque area (23%)</li> <li>• better playground (18%)</li> <li>• centralising active leisure facilities (10%)</li> <li>• Basketball court / stage (8%)</li> </ul>	<p><b>What could be improved:</b></p> <ul style="list-style-type: none"> <li>• basketball court should stay on Hugo Street (28%)</li> <li>• larger playground / more equipment (13%)</li> <li>• no basketball court (11%)</li> <li>• make grassed area larger (10%)</li> <li>• water play area for children (9%)</li> <li>• install public toilets (8%)</li> </ul>

### **Key topics in Redfern Community Centre Open Space submissions**

#### **Basketball court**

Overall sentiment for the Redfern Community Centre Open Space concept design was negative. The location of the basketball court influenced this result with 38% of people suggesting the basketball court should stay on Hugo Street or that there should be no basketball court in the Redfern Community Centre Open Space. This compared with 8% of people saying they liked the court/stage in this location.

Reasons people cited against the court's location at Redfern Community Centre Open Space included noise, the space it takes up, resistance to only having a half-court and the large fence being unwelcoming at the entrance to the park from the train station.

#### **Open space, playground and toilets**

Other suggested improvements included increasing the size of the playground and its equipment (with specific mention of a water play area) and making the grassed area larger. Public toilets were also requested as a companion to the barbeque and playground and because the Community Centre is not always open to access toilets.

#### **What people liked**

40% of people who responded were positive about the concept design and cited the increased green space, barbeque area and upgraded playground as important. There were a number of suggestions that there should be another barbeque area within the park so that more than one group of people could gather at once. 10% of people felt that concentrating active leisure activities like barbeques, playground and the basketball court in this park was positive.

## Yellomundee Park

### Yellomundee Park

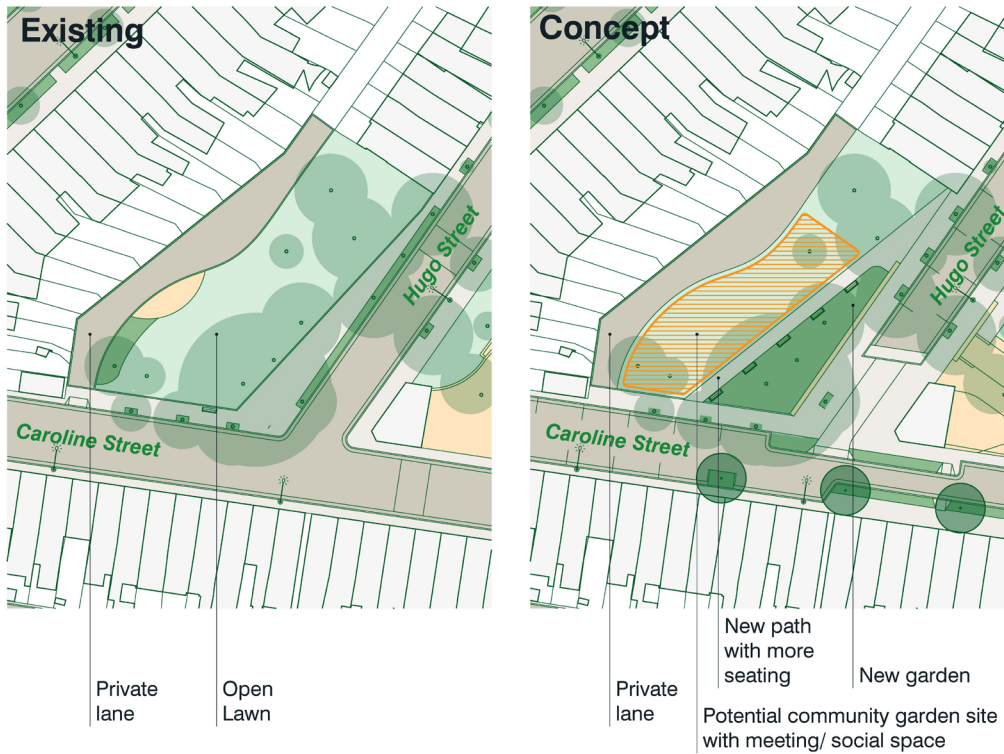

### Overall sentiment

Majority of respondents to this question (56%) were positive or very positive about the design. 25% were neutral and 19% were negative or very negative. A total of 108 people answered this question.

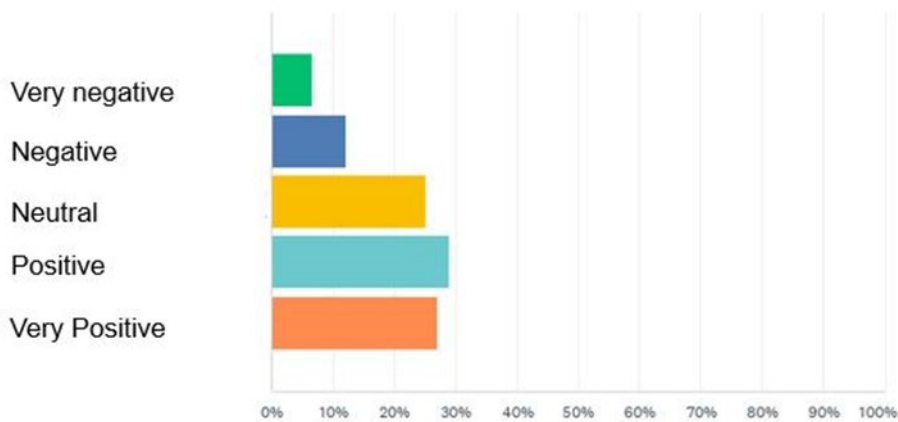

How people felt about this concept

People were then asked what they liked about the design and what could be improved?  
Percentage of 120 people.

**What people liked:**

- community garden (32%)
- more usable community space (16%)
- seating (11%)
- the whole concept (8%)

**What could be improved:**

- more communal seating / yarning (10%)
- bush tucker community garden (10%)
- include Connecting with Country design (8%)

**Key topics in Yellomundee Park submissions**

**Community garden**

The majority of respondents felt positive about the Yellomundee park concept design and key to this result was support for the inclusion within the park of a community garden.

The space was seen as having potential for Connecting with Country design elements with people suggesting it could be a space for cultural ceremony and that the garden should include bush tucker plants with opportunities for educational outcomes. The Aboriginal organisation Wildflower was mentioned a number of times as being a good option for the garden creation.

**Communal seating**

The inclusion of seating detailed in the concept design was supported by the community. However, an improvement that was suggested was the inclusion of communal seating, with community interaction and yarning mentioned.

## Phase 2 consultation – Detailed findings (street calming and greening)

This section provides a detailed analysis of what we heard from the community about three concepts for calming traffic and greening the streets:

1. Traffic calming and greening
2. Discouraging outside traffic – Eveleigh Street
3. Discouraging outside traffic – Changing traffic directions

The most commonly raised comments and questions are listed below for each of the three proposals.

### 1. Traffic calming and greening

This option proposes traffic calming using shared zones, continuous footpath treatments, footpath extensions, blisters, inroad tree planting and a street closure at the northern end of Eveleigh Street.



Whilst there was support expressed for this approach, and traffic calming and greening in general, there were also a wide range of concerns expressed.

### Most common comments related to this proposal

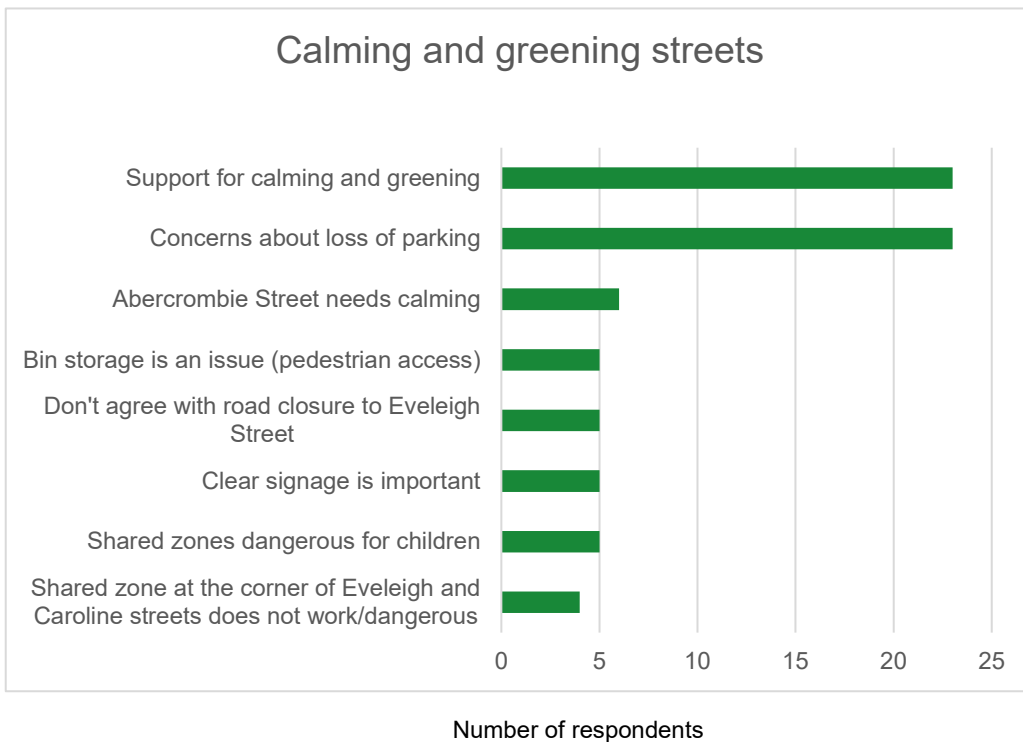

Respondents expressed support for calming and greening the streets.

The most common concern relating to this proposal emphasised the importance of maintaining residential parking spots, including disability parking spots. A related suggestion was to restrict parking in the area to residents-only and extending the number of streets that the resident parking stickers are valid for.

It was also suggested that shared zones can present dangers to children who may not realise they are still walking on a road used by cars. In particular the shared zone on Eveleigh Street between Lawson and Caroline Streets was raised as an issue and is considered dangerous and congested.

Respondents suggested that Abercrombie Street is also in need of calming with pedestrian safety an issue at the intersections with Vine Street and Hudson Street. Respondents also suggested that changes to streets within the current project bounds will have broader traffic and safety impacts on adjacent street networks.

In general, clear signage was seen as an important tool for slowing traffic and keeping people safe around roads.

Some respondents were specifically against closing Eveleigh Street. Other suggestions for calming Eveleigh Street included making it all a shared zone and making it one-way, including running one-way south. There were also suggestions for the closure of Eveleigh Street in other locations including between Lawson and Caroline Streets or between Hudson and Cleveland Streets.



The lack of storage for bins for Caroline and Hugo Street residents was seen as an issue. This leads to the bins being stored on footpaths, making them difficult to navigate for pedestrians.

A number of respondents noted the need for regular maintenance of any extra planting, a preference for non-allergenic plants and the use of non-introduced species.

### **Most common questions related to this proposal**

The primary question being asked by the community related to parking and concerns about how this proposal will impact the number of parking spots. Related questions included: will parking time limits remain as they are and would local residents be exempt from parking fines?

The community was also seeking more information about how this proposal would actually calm traffic or improve safety.

The need for bin storage in the area was again mentioned with one suggestion including an underground bin storage system under Yellomundee Park.

## 2. Discouraging outside traffic – Eveleigh Street

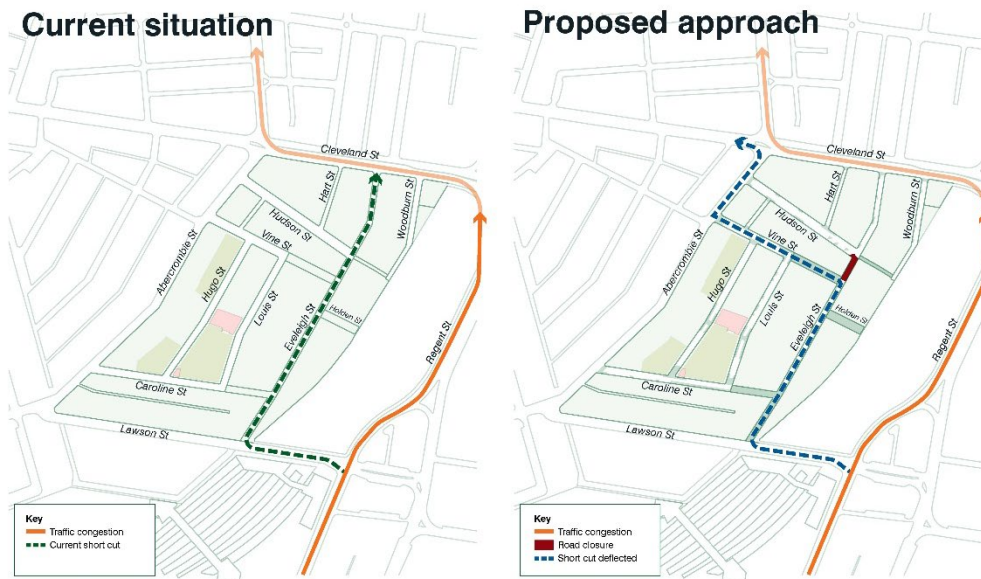

Overall community sentiment was divided regarding this approach and a range of particular concerns were also expressed.

### Most common comments related to this proposal



The most common concerns were that this change would create access problems for residents, increase traffic congestion in the area and push more traffic on to streets that are currently quiet.

Alternative treatments suggested for Eveleigh Street included:

- closing it between Lawson and Caroline Streets where there is currently a shared zone
- making this section of Eveleigh Street one-way
- making Eveleigh Street entirely one-way heading south
- closing Eveleigh Street between Hudson and Cleveland Streets

A number of respondents suggested that traffic calming measures like street planting, chicanes or a 10km per hour zone for the area should be implemented to slow traffic instead of road closures.

People also suggested that ways to minimise non-local traffic coming into the area entirely and improvements to traffic flow in surrounding areas should be considered – these included;

- closing Eveleigh Street at Lawson Street
- making parking in the area only for residents and their guests
- improving traffic flow along Lawson onto Gibbons and from Regent onto Cleveland (potential for slip lane) to avoid traffic bottlenecks

#### **Most common Questions related to this proposal**

A number of questions were asked in relation to this proposal, these included:

- How will this reduce speed or improve safety?
- How does this discourage drivers from entering the area
- What road data supports the conclusion that Eveleigh Street is being used as a shortcut to Cleveland Street?

### 3. Discouraging outside traffic – Changing Directions



Overall community sentiment was divided regarding this approach and a range of particular concerns were also expressed.

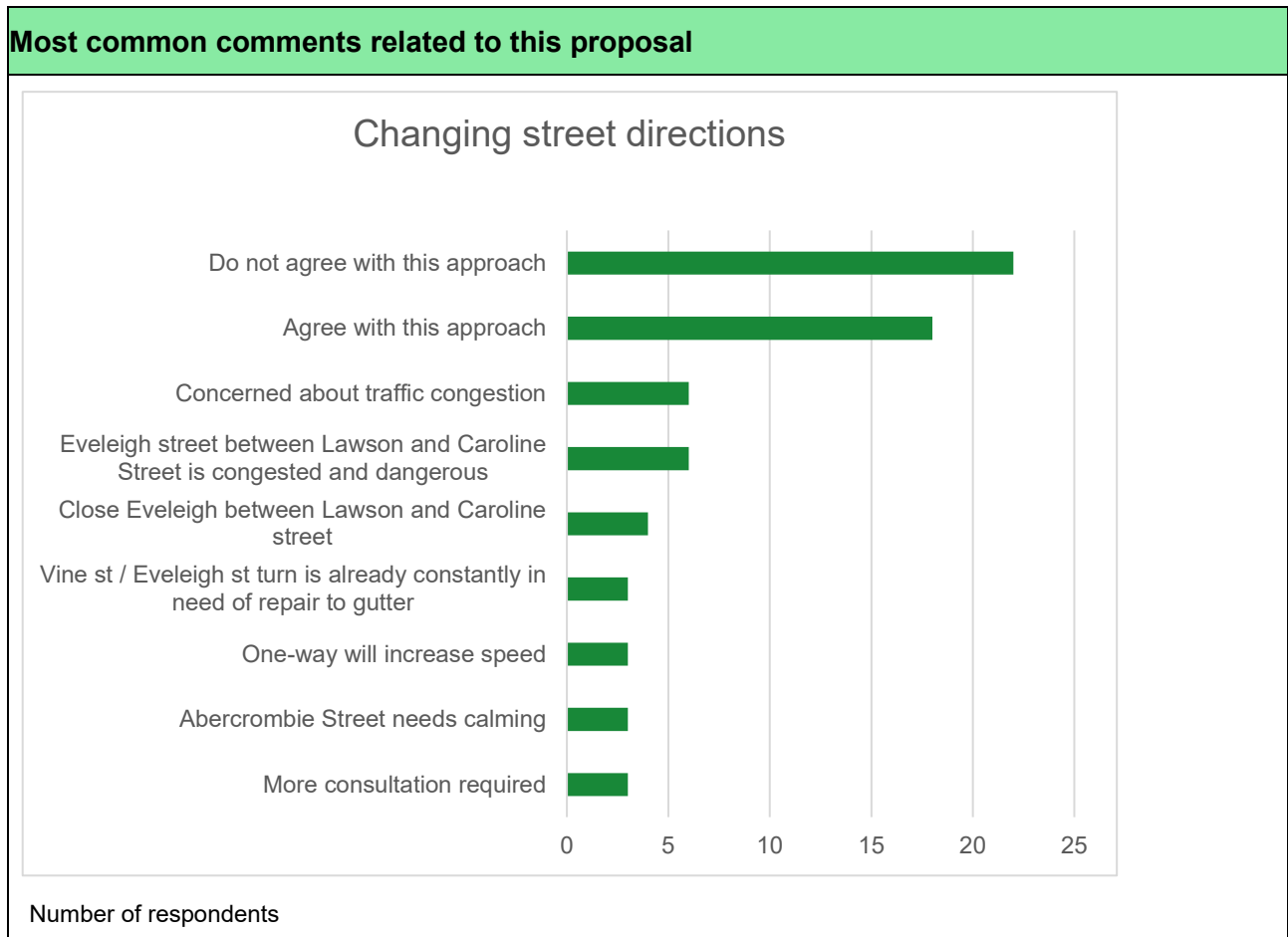

The concerns that were raised included that this approach could increase traffic congestion in the area and that making streets one-way would allow cars to travel faster rather than slower. It was noted that the corner of Eveleigh and Vine streets is already constantly in need of repair.

Respondents again suggested that an area of concern is the shared zone on Eveleigh Street between Lawson and Caroline Streets, with the suggestion again made that it should be closed to traffic.

A number of respondents again suggested that parking changes be considered to reduce traffic into the area. It was noted that the flow of cars entering and exiting the area looking for parking should be considered when determining the directions of one-way roads.

It was suggested that if streets changed to one-way that cyclists should still be allowed to travel in both directions.

It was noted that the wider traffic context should be considered – particularly the calming of Abercrombie street for pedestrians and its interaction with Cleveland Street and the way traffic on Eveleigh Street, Lawson Street and Little Eveleigh Street interacts.

A number of community members felt further community engagement was required to develop traffic calming options in the area.

### **Most common questions related to this proposal**

Questions that were raised about this proposal included:

- will cyclists be restricted to one-way travel?
- how does this approach slow traffic?
- how will this approach deter traffic from entering the area?

## Phase 3 consultation – Detailed findings (parks revised design)

*This section provides a detailed analysis of what the community told us during phase 3 consultation where feedback was sought on the revised designs for 3 local parks: Hugo Street Reserve, Redfern Community Centre Open Space & Yellomundee Park.*

The City listened to community feedback gathered in Phase 2 of the consultation and revised the plans for Redfern Community Centre Open Space, Yellomundee Park and the Hugo Street Reserve accordingly.

Phase 3 of the consultation invited the community to provide feedback on these plans. Data was collected via email submissions (10 submissions were received) and at a community meeting at the Redfern Community Centre on the 12 October. This meeting saw the new plans displayed with presentations by the Lord Mayor, City design staff and City community consultation staff – 47 community members attended this meeting leaving 66 comments on the displayed plans.

The community were updated on next steps regarding calming and greening streets which was that Phase 2 feedback would be used to inform a Local Area Traffic Management plan (LATM). Further comments regarding calming and greening streets were also collected but this was not the primary purpose of this phase of the consultation.

### Overall sentiment

A large majority of respondents were supportive of the overall revised plans.

70% (46) of the 66 comments made by respondents at the community meeting were positive about the overall redesign and 27% (18) of the remaining comments were focused on constructive additions to the plans. 3% (2) of the 66 comments were negative and will be outlined in the relevant park sections below.

70% (7) of the 10 written submissions received via email expressed overall support for the redesign plans, as well as making some constructive suggestions. 30% (3) of the respondents focused more entirely on supplying suggestions or raising concerns.

Comments of overall support:

*Many generations of Aboriginal people have lived here and we can educate visitors, tell stories and be a resource. Thank you for listening to feedback and upgrading the design. Continue to work with us, we have so much knowledge, such as what plants to use.*

*I strongly support the revised plan for Redfern Community Centre and surrounds.*

*I think overall the plan is going in the right direction and the current changes are looking great. Thanks for all your listening and excellent efforts.*

*Overall, I think all aspects of the plan seem like an improvement. Thank you for the community engagement.*

## Redfern Community Centre Open Space – revised plans

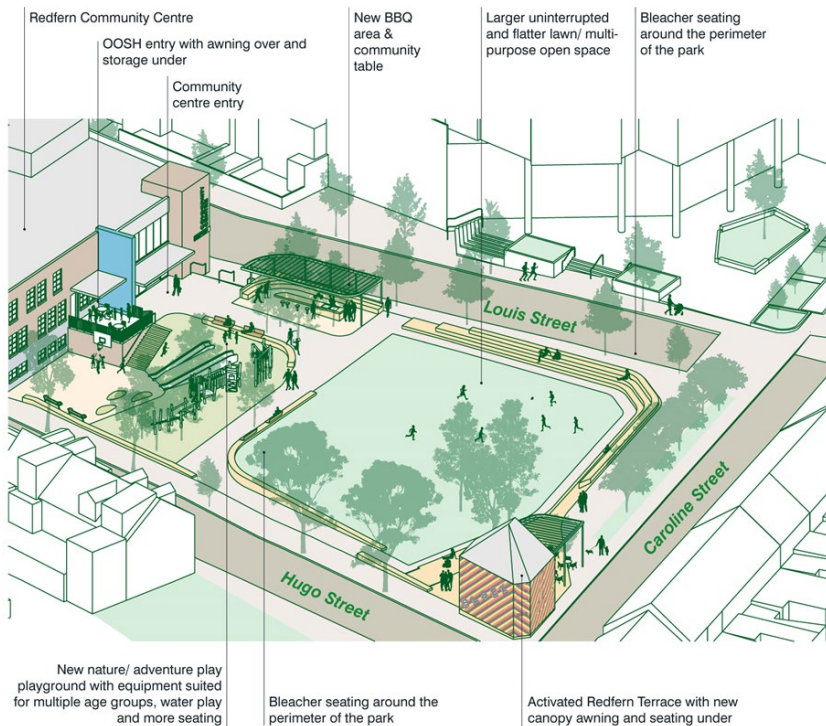

### Features

- A hub for the local community
- Existing diagonal ped. desire line re-routed
- Larger fit-for-purpose lawn/ community green area. Could include water play elements
- Amphitheatre terraces turned into playground area with flat multipurpose area at the base
- Larger OOSH entry/ terrace area
- BBQ and community table/ bench near community centre entry
- Redfern terrace activated with canopy covered forecourt
- Hardstand area adjacent to Redfern Terrace available for event gazebos.
- More lighting and power

## Community meeting

A large majority of people making comments at the community meeting were positive about the revised plans for the Redfern Community Centre Open Space. Of the 39 comments pertaining to this park 79% (31) were positive. People particularly liked:

- Larger green space
- BBQ area
- Larger playground – in particular the addition of waterplay
- Love the Redfern terrace – possible café space (don't want an art gallery to double up with new art gallery (Pemulwuy/ Aboriginal Housing Corp).

Of the 39 comments 18% (7) comments were suggested improvements, including:

- Install lights for night activities
- Install a sound system
- Provide enough rubbish bins
- Add outdoor exercise equipment

Of the 39 comments 3% (1) comment preferred the previous design with the basketball court in the park.

## Email written submissions

Of the 8 respondents that provided comments regarding Redfern Community Centre Open Space 88% (7) were supportive overall of the revised plans, making particular mention of:

Engagement report – Redfern neighbourhood vision and plan:  
Phase 2 and 3

- Green space
- Perimeter seating
- BBQ area
- Playground

Of these 7 respondents 3 also raised a number of suggestions or concerns including:

- Children’s play area does not need waterplay
- Could activity play for tweens / teens also be provided
- Provide bubblers and a toilet
- Keep metal structure on Caroline Street and add shade.
- Display map / information near community centre depicted this area before European settlement, including the waterways, hills, flora, fauna and land usage of the Gadigal people.

There was 1 respondent primarily opposed to the Redfern Community Centre Open Space redesign citing a range of concerns:

- metal structure should be retained on Caroline Street with additional shade, rain protection, greenery
- increased grass area and use will lead to grass erosion and dust issues
- noise issues with more people using the grassed area

### Yellomundee Park – Revised Plans



The majority of residents supported the original concept for Yellomundee Park which included in Phase 2 of the consultation – this included:

- More seating
- More lighting
- New path on pedestrian desire line between Caroline and Hugo streets
- Potential site for community garden with bushtucker plants/ plants used in the practice of culture

Additionally the community suggested the need for the inclusion of an outdoor gathering/ social space for sharing knowledge and culture. This was included in the revised plan.



## Engagement report – Redfern neighbourhood vision and plan: Phase 2 and 3

1. Private lane
2. New path with seating
3. Potential public garden or community garden space
4. Gathering/ social/ learning space

### Community Meeting

6 comments were made regarding Yellomundee Park at the community forum, 3 were positive and 3 were suggestions.

People particularly liked:

- Bush food garden
- Seating

Suggestions included:

- Moving seats near paths into the garden
- Add a BBQ
- Add tables
- Take into account rubbish storage
- A grant to support the community grant should be created

### Email written submissions

4 email respondents commented on the revised Yellomundee plans.

3 people supported the community garden and had the following suggestions and questions:

- Would any of the trees need to be removed (shady area)?
- Please do not cut any trees down
- Would there be a waiting list for plots?
- Can the council organise a workshop how to start and run a community garden?
- Community participation and strict (but fair) governance are required for a successful community garden
- Spigots and hoses would be required.

Additional comments regarding Yellomundee Park included:

- Stop local residents using the park (lane) as a driveway/storage area
- Can Yellomundee park also be used to accommodate residents bin storage (old terrace houses on Hugo Street have nowhere to store bins on their property).

1 email respondent raised the following concerns about the plans for Yellomundee Park:

- Parks need better maintenance
- Opposed introduction of new paths
- People like the grass and use park for their dogs
- Add borders around trees to keep bark in
- Add two bins along footpath
- Add a small (gated) box plant border (no bigger than 400mm) Caroline Street and Hugo Street side between park and sidewalk.
- Bench seats moved back into the edge of the park.

## Hugo Street Reserve – Revised Plans

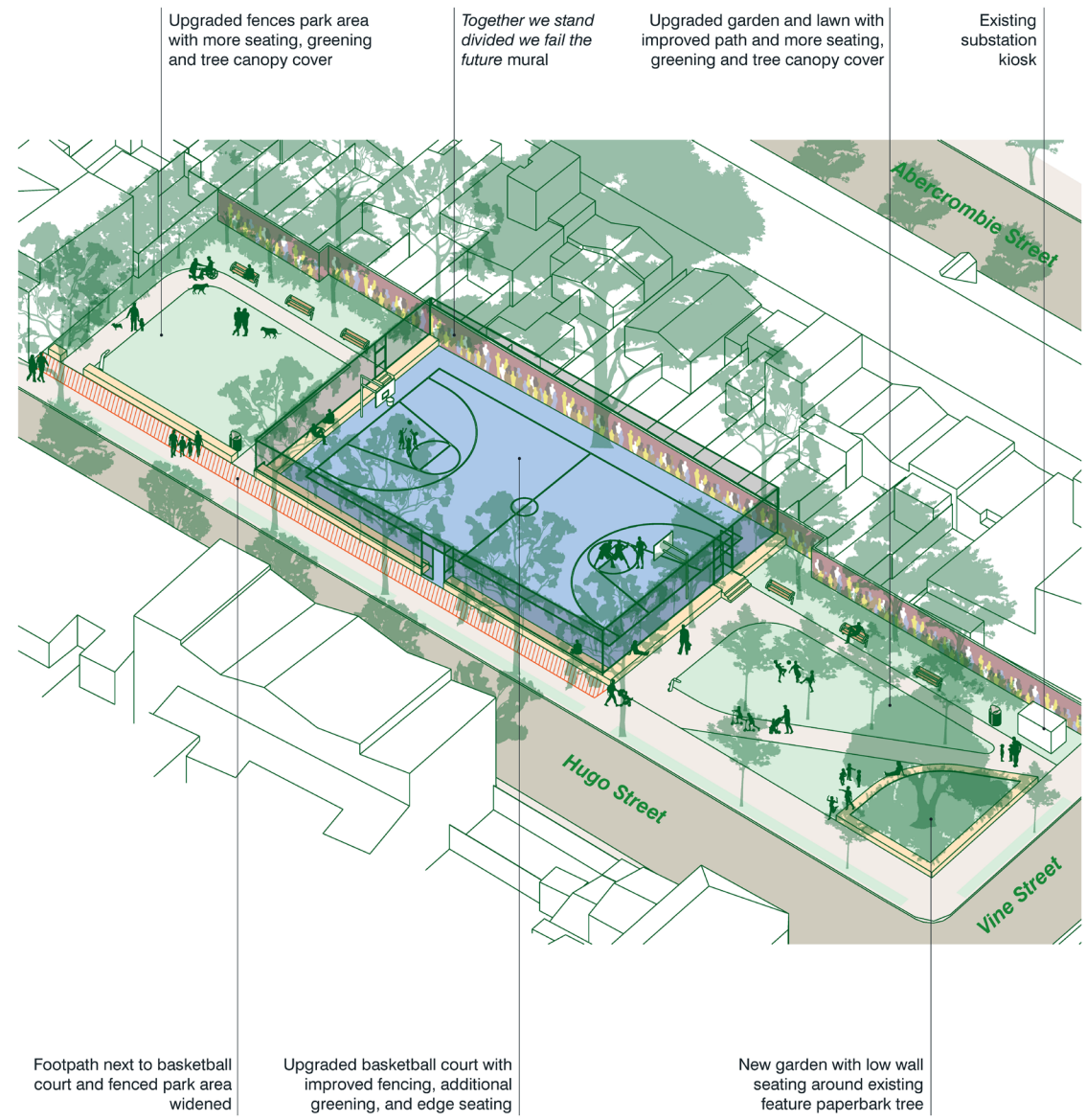

This plan was revised in line with Phase 2 community feedback:

- the Basketball court staying at its current location
- noise mitigated at the source: replace court flooring with noise reducing surface, sturdier basketball hoop towers with noise reducing backboards, investigate/incorporate sound absorption material into mural wall, reduce hours of operation (close court at 8pm rather than 9pm), investigate suitability of higher fences and introduce more greening along court fence.
- lawn areas upgraded with more seating, lighting and tree canopy where possible.

## Community Meeting

21 comments were made about the Hugo Street Reserve at the Community meeting, 19 about the Basketball Court and 2 regarding the Dog Park area.

## **Basketball Court**

19 comments were made regarding the Basketball Court.

10 comments were in favour of the plan to keep and upgrade the court in its present location with 1 comment against:

- *Deadly to see the basketball court saved*
- *Love the design – thanks for keeping the basketball court*
- *Basketball court is in the perfect space!*
- *Coloured court surface please*
- *This basketball court has made local heroes; my son is in the national basketball league thanks to this court.*

The remaining 8 comments were suggestions on how to further improve the plan, including:

- Noise mitigation measures: make court indoor or surround court in 6 inch glass wall
- Make fence design less like a cage
- Include lights
- Will access be effected by daylight savings?

## **Dog Park**

2 comments were made regarding the dog park on Hugo Street reserve with both in favour of retaining a fenced dog park in this location.

## **Email submissions**

6 email submissions commented on the revised plans for the Hugo Street Reserve, comments were again focused on the Basketball Court and the Dog Park.

## **Basketball Court**

### **5 comments were made about retaining the Basketball Court:**

3 comments were in support of retaining the court.

- *I am also a strong advocate for the proposed basketball court, including the suggested flooring solution.*

2 comments made suggestions for improving the design

- *Move the basketball court to the northern end of Hugo Street and consolidate the two parks*
- *Making the court a half a court to help mitigate the risk of having large groups playing*

## **Dog Park**

4 comments were made regarding the dog park, all in support of retaining it as either a fenced area (2 supported) or unfenced off-leash area (2 supported).

Other suggestions included:

- Improve groundcover – more hardy species of grass or better synthetic cover with good drainage

## Engagement report – Redfern neighbourhood vision and plan: Phase 2 and 3

- Make a larger off-leash area by consolidating the two parks
- Dog activity equipment installed
- Border hedge (300-400mm wide) around the edge of area
- No pathways/gravel walkways through site

### **Calm Traffic, improve safety and increase greening on streets**

Phase 3 of the consultation acknowledged the importance of calming and greening the streets. The community was informed that this will be done as a separate project to the parks upgrades.

Changing streets is complex and requires significant technical input. It also requires the creation of a local area traffic management plan, multiple approvals and additional community engagement at various stages. The proposed process for doing this was outlined at the community meeting:



The community made a range of comments regarding plans for calming and greening streets at the community meeting and in email submissions – they are summarised as follows:

### **Calming the streets**

The community reiterated that calming the streets is an important safety issue that they consider a priority.

Traffic management within the consultation area should be integrated with the wider area and specifically with Transport for NSW (TfNSW)'s proposal and traffic plan. Specific suggestions mentioned were:

- Calming Abercrombie Street
- Include Lawson Street in the upgrade (particularly the footpaths).
- Integration with changes being made on the southern side of Lawson Street (in particular Little Eveleigh Street)

Engagement report – Redfern neighbourhood vision and plan:  
Phase 2 and 3

- Consider the impact of Sydney University's growth plans and related impact on streets, transport and people movement
- Consider the area's relationship with the whole street network that connects Sydney Uni and the Redfern Train Station
- Improve access of garbage trucks down Little Eveleigh Street

Specific traffic management suggestions within the project area were:

- Make Caroline Street 1-way
- Make Caroline Street a shared zone extended from Eveleigh Street
- Caroline Street: parking on one side, level and increase the size of the footpath so that people can access the houses and store bins.

### **Parking**

- Loss of parking on Lawson Street and Little Eveleigh Street was identified as a particular issue by the community with particular mention of the introduction of no stopping zones by TfNSW on Little Eveleigh Street.
- Do not reduce parking spots for residents or disabled parking spots in the area
- Make getting parking permits easier
- Caroline Street (Redfern Community Centre street side): decrease the parking time from free to less than 2 hours.
- Better manage parking issues when large-scale construction occurs in the area so residents are not disadvantaged
- Increase parking ranger presence in the area.

### **Greening**

- Increase trees on Eveleigh Street was requested
- Verge planting by council on Abercombe street was praised but that it requires trained gardeners to take care and maintain the vegetation.
- It was mentioned that community members have added to the Abercrombie Street verge gardens but observed council contractors pulling out plants thinking they were weeds. Community members request that residents and Council Gardeners are able to meet annually to coordinate the street planting efforts.

### **Signage**

- Community requests a street sign on Eveleigh Street directing to Redfern Community Centre and Aboriginal Housing Corp. to match City of Sydney guided tour, like the sign for Aboriginal Dance Theatre on Redfern Street.

### **Waste and Cleaning**

Waste and cleaning within the local streets was raised as a significant issue, in particular:

- Litter dropped by people passing through the area, specifically university students and students residing at Scape. Particular streets mentioned: Abercrombie Street, Louis Street and Little Eveleigh Street.
- Solutions for littering mentioned were: education programs for students, more regular street cleaning and emptying of bins.
- Ensure there are enough bins installed in the parks and they are located in the right positions
- Suggestion that a bin be installed at the corner of Hugo Street and Vine Street

Engagement report – Redfern neighbourhood vision and plan:  
Phase 2 and 3

- Residential bin storage is an issue for many of the terrace houses in the area. Solutions suggested include wider footpaths and a storage facility in Yellomundee Park.

### **Construction Noise**

Residents noted that construction noise has been an issue and requested:

- builders to minimise noise as much as possible
- builders not to block off stretches of road, which creates parking issues
- builders should not litter the area

# Engagement activities

---

## Overview of engagement undertaken:

### **Sydney Your Say webpage**

A [Sydney Your Say webpage](#) was created for Phase 2 and 3.

Phase 2: The page included an electronic copy of the Phase 1 consultation report, an electronic copy of the survey (including concept designs) and a link to the online survey.

Phase 3: The page included a summary of feedback from Phase 2, a downloadable PDF version of the revised plans and submission instructions.

### **Online feedback form via Survey Monkey**

The community and stakeholders were able to give feedback using an online feedback form during Phase 2. A link to the feedback form was provided on the Sydney Your Say website.

### **Sydney Your Say e-news**

The Phase 2 consultation was included in the Sydney Your Say (June 2023) e-newsletters (6,877 subscribers).

### **Consultation letters**

The core consultation distribution area included 1860 residents and owners in the streets surrounding the Redfern Community Centre. Over the course of the consultation three letters were sent:

Phase 2: A letter was delivered to residents and owners on 16 June inviting them to attend the community meeting and give feedback on the plans.

Phase 3: A letter was delivered to residents and owners on 16 August informing them of the decision to retain the Hugo Street Basketball court in the Hugo Street location based on feedback from the Phase 2 consultation.

Phase 3: A letter was delivered to residents and owners on 27 September inviting them to attend the community meeting and give feedback on the revised plans.

### **Notification email letter**

An email was sent to over 300 key stakeholders during phases 2 and 3 inviting them to the community meetings and to give feedback on the proposal.

### **Community consultation community meetings**

Two community events were held to support the engagement of this project.

The first, held as part of Phase 2 on 29 June, was attended by 60 residents and stakeholders.

The second, held as part of Phase 3 on 12 October, was attended by 47 residents and stakeholders. Their feedback has been incorporated into the key findings of this report.

### **On-site signage**

Phase 2 and 3: in each phase notice boards were installed in Redfern Community Centre Open Space, Yellomundee Park, the Hugo Street Reserve (dog park and basketball court), at the Redfern Community Centre entrance and inside at the centre at the reception desk inviting people to give feedback on the proposal.



# Appendices

---

## Appendix A: Communications activities

The following is a snapshot of outcomes from marketing and communications activities undertaken to support the consultation. Activities reached a range of audience segments through existing City of Sydney channels.

<b>Activity</b>	<b>Outcome</b>
<b>Sydney Your Say webpage</b>	<ul style="list-style-type: none"><li>• Phase 2: 296 unique page views / 90 document downloads</li><li>• Phase 3: 268 unique page views / 63 document downloads</li></ul>
<b>Lord Mayor letter</b>	<ul style="list-style-type: none"><li>• The core consultation distribution area included 1860 residents and owners:<ul style="list-style-type: none"><li>• Phase 2: consultation invitation, sent 16 June.</li><li>• Phase 3: Hugo Street Basketball Court letter, sent 16 August.</li><li>• Phase 3: consultation invitation letter, sent 27 September.</li></ul></li></ul>
<b>Notification email to key stakeholders</b>	<ul style="list-style-type: none"><li>• Phase 2: Consultation notification emails sent to 289 key stakeholders on 16 June and 312 key stakeholders on 3 July.</li><li>• Phase 3: Hugo Street Basketball court notification email sent to 101 stakeholders on 14 August (all phase 1 consultation participants who supplied contact details).</li><li>• Phase 3: Consultation notification email sent to 346 key stakeholders on 27 September.</li></ul>
<b>eNewsletters</b> Sydney Your Say June edition	<ul style="list-style-type: none"><li>• To 6,877 subscribers on 28 June</li></ul>
<b>On site signage</b>	<ul style="list-style-type: none"><li>• Phase 2 and 3: in each consultation phase 10 notification signs were displayed in local parks, streets and at the Redfern Community Centre.</li></ul>

## Sydney Your Say Webpage

Sydney Your Say webpages were used in Phases 2 and 3 and included a survey link, Phase 1 Consultation Report and downloadable neighbourhood plans.



### What we're doing

We asked for feedback to help shape a community vision and plan for Redfern in November and December 2022.

We heard that in the future the community see the neighbourhood as:

- a place that celebrates its Aboriginal culture and history
- a place that is green and cool with native trees and plants
- a safe place to move around and play
- a place where people feel a sense of connection and belonging
- a place where the community can come together to socialise and celebrate.

This community vision has helped us shape a plan to improve the local parks and streets. We now invite you to provide feedback on the draft plan.

The plan involves 3 main opportunities:

- improvements to Redfern Community Centre Park
- improvements to Yellowmunde Park and Hugo Street Reserve
- slowing traffic and greening the streets.

**Have your say**  
Complete our feedback form by 5pm on Thursday 20 July.  
[Online form](#)

**Gareth Jenkins**  
SENIOR COMMUNITY ENGAGEMENT COORDINATOR - CITY ENGAGEMENT  
[Show details](#)

**Calley Clarke**  
BUSINESS SUPPORT OFFICER - CITY ENGAGEMENT  
[Show details](#)

## Notification via eNews

- Inclusion in Sydney Your Say eNewsletter on 28 June (6,877 subscribers)

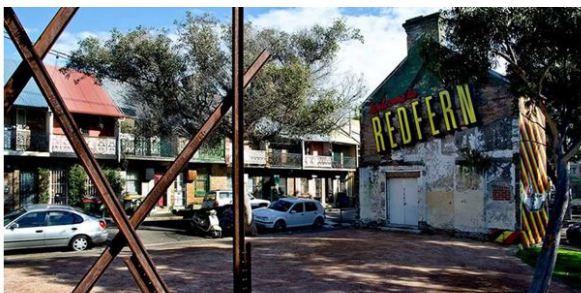

### Redfern neighbourhood vision and plan

In late 2022 our community told us their vision for the neighbourhood. This vision has helped us shape a plan to improve local parks and streets. We now invite your feedback on the draft plan.

Have your say by Thursday 20 July.

[Read more](#)

# Engagement report – Redfern neighbourhood vision and plan: Phase 2 and 3

## On site Signage

On site signage in local area was erected during both Phase 2 and 3 of the consultation including illustrations of proposed plans and QR codes linking to the consultation webpage.

### Phase 2



### Phase 3



**Letter from the Lord Mayor notifying local community members of the consultation - example:**



THE LORD MAYOR OF SYDNEY  
**CLOVER MOORE**

16 June 2023

Dear Resident

**Neighbourhood plan**

I invite you to a workshop to give feedback on the City of Sydney's plan for the parks, public spaces and streets surrounding the Redfern Community Centre.

**Creating the vision**

In November last year, we asked the community to help create a vision to shape the public spaces around the Redfern Community Centre.

You told us you value the strength of Aboriginal culture and history in the neighbourhood. You value the sense of community spirit, the walkability of the area, its low-rise heritage buildings, and the green spaces and trees.

In the future, you see the neighbourhood as green and cool, with native trees and plants, and a safe place to move around and play. People feel a sense of connection and belonging, and there are places where you can come together to socialise and celebrate.

We would now like to tell you about our plan to improve the local parks and streets.

**Next steps**

I will host a community workshop to discuss the plan at the Redfern Community Centre at **5.30pm on Thursday 29 June**.

You can register to attend and find out more at [cityofsydney/redfern-sys](https://cityofsydney.nsw.gov.au/cityofsydney/redfern-sys).

For more information or if you have any questions, please contact Gareth Jenkins, Senior Project Manager – City Engagement, at [sydneyyoursay@cityofsydney.nsw.gov.au](mailto:sydneyyoursay@cityofsydney.nsw.gov.au) or on 02 9265 9333.

Yours sincerely

A handwritten signature in black ink that reads "Clover Moore".

Clover Moore  
**Lord Mayor of Sydney**

**Email to key stakeholders notifying them of the consultation - example:**



## **Redfern/Darlington community meeting and update**

I invite you to join me for an update on the City of Sydney's plans for the parks, public spaces and streets surrounding the Redfern Community Centre.

Earlier this year, we sought feedback on our Redfern Neighbourhood Vision and Plan. Based on this feedback, we have developed a revised plan for our upgrade of the area.

I will host a community meeting about the revised plan on **Thursday 12 October** at the **Redfern Community Centre, 29-53 Hugo Street**.

The meeting will start at **6.30pm** with food being served and the revised plan on display. This will be followed by presentations from **7pm**. We expect the meeting to finish at **8pm**.

I look forward to hearing what you think. If you plan to attend, please register on the City's website at **city.sydney/redfern-sys**. You will also be able to use that link to give your feedback online between 13 and 27 October.

If you have any questions, please contact Gareth Jenkins, Senior Project Manager – City Engagement, on 02 9265 9333 or at [sydneyyoursay@cityofsydney.nsw.gov.au](mailto:sydneyyoursay@cityofsydney.nsw.gov.au).



A handwritten signature in black ink that reads "Clover Moore".

Clover Moore AO  
Lord Mayor of Sydney

---

The City of Sydney acknowledges the Gadigal of the Eora nation as the Traditional Custodians of our local area.

Engagement report – Redfern neighbourhood vision and plan:  
Phase 2 and 3

Engagement report – Redfern neighbourhood vision and plan:  
Phase 2 and 3

Photos from Community meeting: June 29

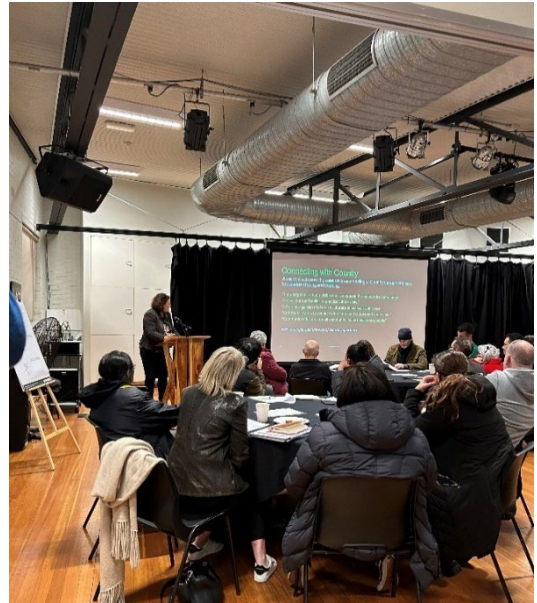

Photos from Community meeting: October 12



## Appendix B: A selection of the consultation materials

### Phase 2 consultation materials

## Project 2 - Improve the supporting parks

### Yellomundee Park



How do you feel about this concept?

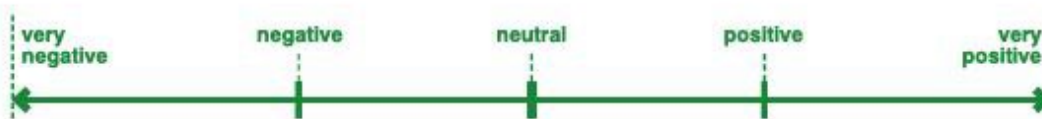

What do you like about this concept?

How could this concept be improved?



Phase 2 consultation materials

## Project 2 - Improve the supporting parks

### Hugo Street Reserve



How do you feel about this concept?

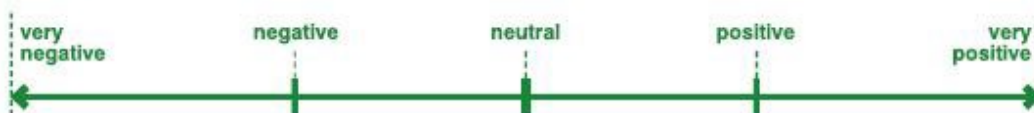

What do you like about this concept?

How could this concept be improved?

Phase 2 consultation materials

## Project 3 - Calm traffic, improve safety & green streets



Do you have any comments on this approach?

Do you have any questions about this approach?

**Phase 3 consultation materials**

**Project 1 - Strengthening the community heart**  
**Redfern Community Centre open space - Updated concept**



Example of park materiality: Royal Park Nature Play playground, Melbourne

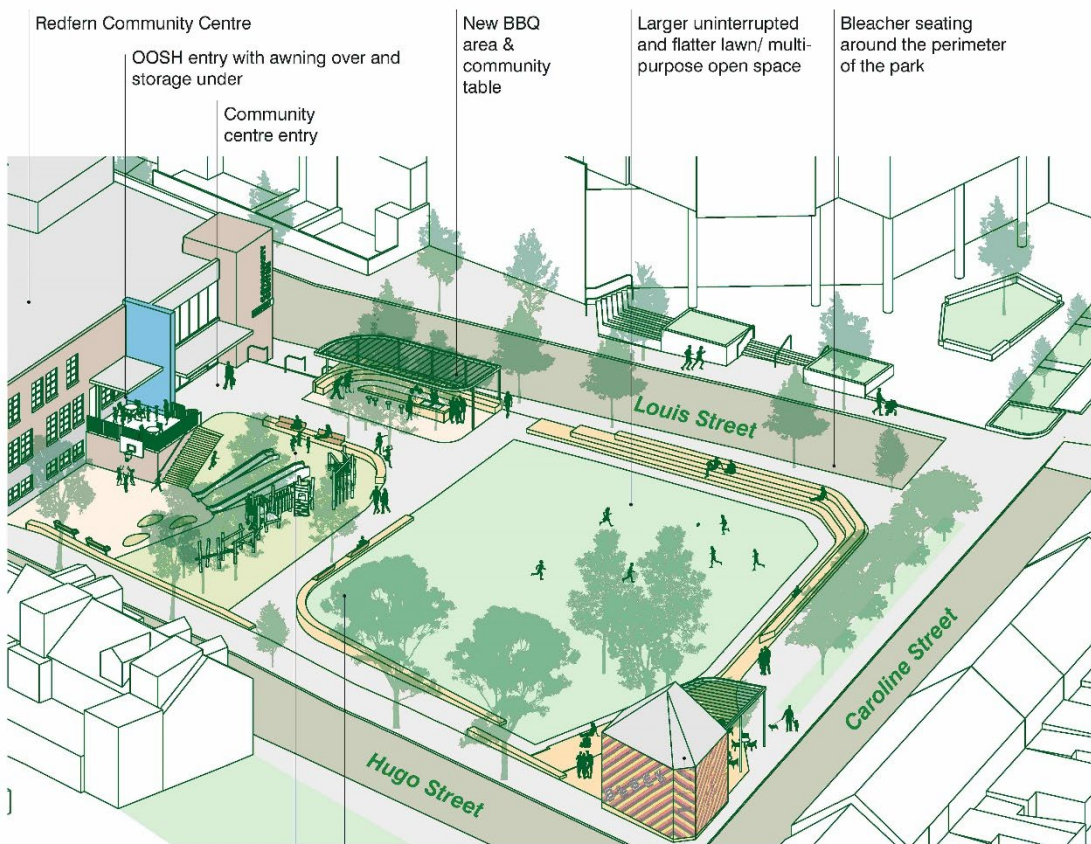

New nature/ adventure play playground with equipment suited for multiple age groups, water play and more seating

Bleacher seating around the perimeter of the park

Activated Redfern Terrace with new canopy awning and seating under

Example of nature play: 5 Senses Garden, Concord



Phase 3 consultation materials

## Project 2 - Improve the supporting parks Hugo Street Reserve



Hugo Street Reserve

### Existing plan

1. Basketball court
2. Garden and lawn
3. Fenced park area

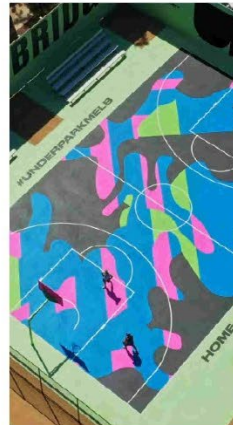

Example: Basketball court mural by Reko Rennie

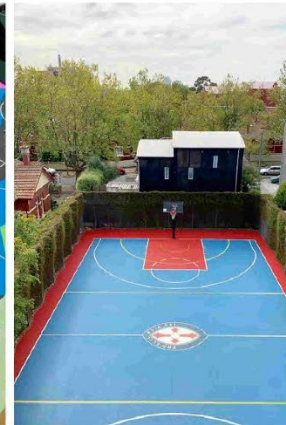

Example: Dreamcourt basketball surface in urban context

### Updated Concept

1. Upgraded basketball court
2. Upgraded garden and lawn
3. Upgraded fenced park area
4. Widened footpath

Phase 3 consultation materials

## Project 2 - Improve the supporting parks

### Hugo Street Reserve - basketball court improvements

#### Move 1

Replace court flooring with noise reducing surface

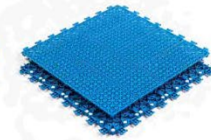
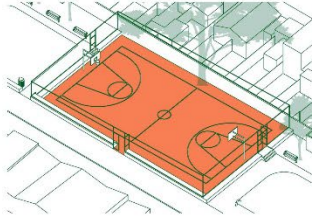

#### Move 2

Install sturdier basketball hoop towers with noise reducing backboards

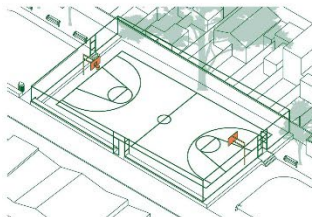

#### Move 3

Investigate/ incorporate sound absorption material into mural wall

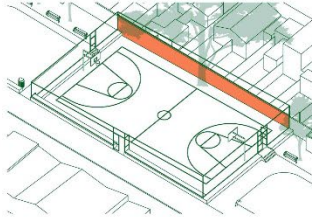

#### Move 4

Reduce hours of operation. Close court at 8pm rather than 9pm

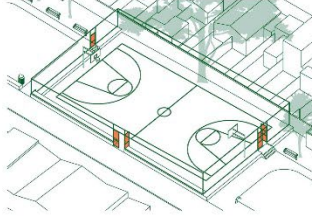

#### Move 5

Investigate suitability of higher fences

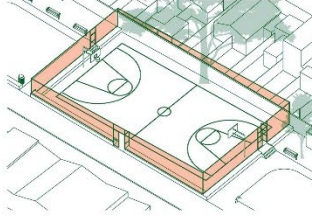

#### Move 6

Introduce more greening along court fence

